

Outside screw and yoke, Rising stem Bolted bonnet, Plug disc

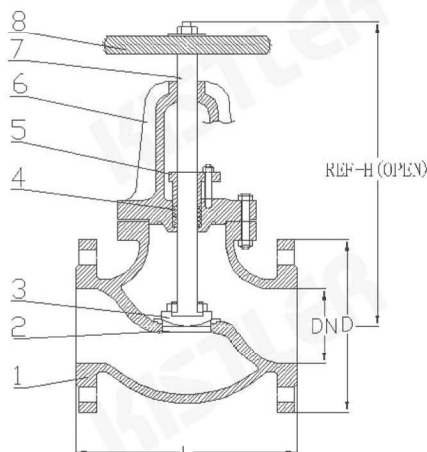

Fig. GLB-301 (ANSI150)

GLB-302 (JIS10K)

GLB-303 (PN10)

GLB-304 (PN16)



SPECIFICATION

- Designed and Manufacture JIS B2031
- Face to Face dimensions :
ASME B16.10, JIS B2210
- Pipe flanges end : ASME B16.1, JIS B22P

FEATURE AND APPLICATION

1. Outside screw and yoke, Rising stem.
2. Hand wheel operation, Flanged End Connections.
3. Bolted bonnet, Plug Disc Desing.
4. For General and Industrial Service.
5. Water, Oil, Gas and Steam.

MATERIALS

NO.	NAME OF PARTS	MATERIAL
1	Body	Cast Iron (A126, FC200, HT200)
2	Seat seal ring	Stainless Steel (CF8, SCS13, SUS304)
3	Disc	Cast Iron (A126, FC200, HT200)
4	Packing	Non-Abestos (option: Graphite)
5	Gland	Cast Iron (A126, FC200, HT200)
6	Bonnet	Cast Iron (A126, FC200, HT200)
7	Stem	Stainless Steel 410
8	Hand wheel	Cast Iron (A126, FC200, HT200)

PERFORMANCE

Application	Max. Working Pressure & Temperature	Test
Water & Oil	200 psi. (14 bar) 120°C	- Hydrostatic shell test 25 bar
Saturated Steam	70 psi. (5 bar) 120°C	- Hydrostatic seat test 15 bar
		- Air Test 6 bar

DIMENSIONS

Unit : mm

SIZE inch.	H	L	JIS10K			ANSI150			PN10			PN16		
			D	C	N	D	C	N	D	C	N	D	C	N
2"	260	203	155	120	4	152	121	4	165	125	4	165	125	4
2.1/2"	285	216	175	140	4	178	140	4	185	145	4	185	145	4
3"	310	241	185	150	8	191	152	4	200	160	8	200	160	8
4"	325	292	210	175	8	229	191	8	220	180	8	220	180	8
5"	385	330	250	210	8	254	216	8	250	210	8	250	210	8
6"	415	356	280	240	8	279	241	8	285	240	8	285	240	8
8"	485	495	330	290	12	343	299	8	340	295	8	340	295	12
10"	535	622	400	355	12	406	362	12	395	350	12	405	355	12
12"	625	698	445	400	16	483	432	12	445	400	12	460	410	12